

RECOMMENDED MOUNTING PATTERN

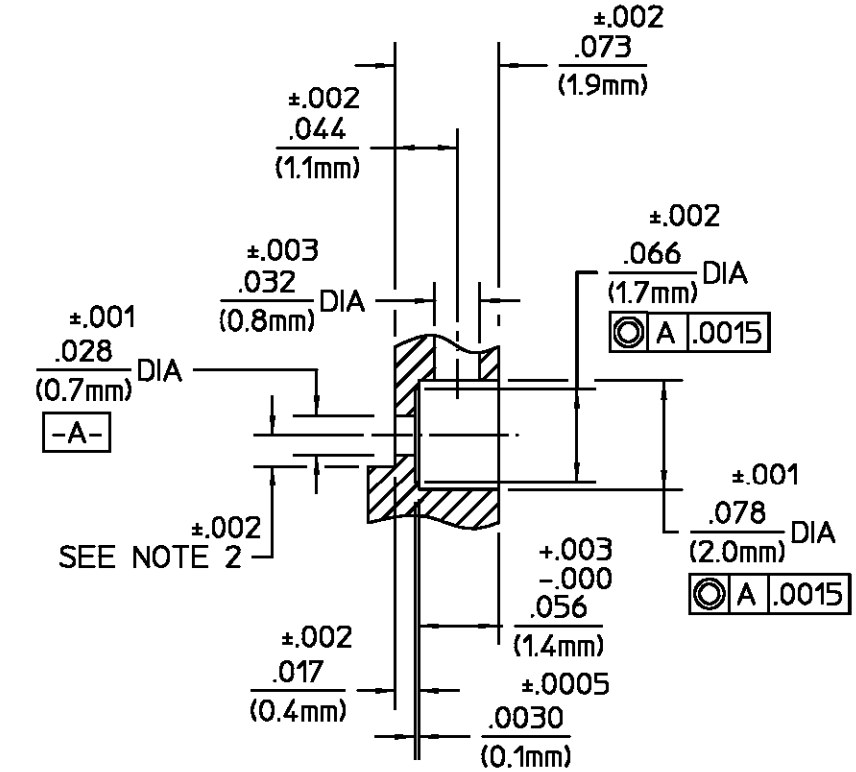

RECOMMENDED MOUNTING HOLE  
SCALE: 8:1

.XXX = in  
XX.X = mm (REF)

REVISIONS			
REV	DESCRIPTION	DATE	APPROVED
03 <sub>0</sub>	RELEASED WAS UNRELEASED	4-27-92	<i>CAF</i>
B	PER EC 0U20-0116-01-05	19NOV01	<i>C. Hoang</i>

NOTES:

1. CAPTURED CENTER CONTACT
2. DIMENSION IS .006 (PIN RADIUS) + SUBSTRATE THICKNESS + SOLDER THICKNESS
3. FOR RECOMMENDED MOUNTING HOLE FOR USE WITH SLIDING CONTACT SEE AP# 48-007

HOUSING	STAINLESS STEEL PER ASTM-A484 AND ASTM-A582, TYPE 303	PASSIVATE PER ASTM-A380
BUSHING	BERYLLIUM COPPER PER ASTM B 196, ALLOY C17300, CONDITION H	GOLD PLATE PER MIL-G-45204 OVER NICKEL PLATE PER QQ-N-290
SUPPORT BEAD	NORYL PPO EN265 COLOR: BLACK	N/A
CENTER CONTACT	BRASS PER ASTM-B-16, HALF HARD	GOLD PLATE PER MIL-G-45204
COMPONENT	MATERIAL	FINISH

UNLESS OTHERWISE SPECIFIED DIMENSIONS ARE IN INCHES TOLERANCE ON FRAC. DEC. ANGLES ± 1/64 ±.005 ± °	DRAWN BY <i>MC</i> DATE 4-24-92	AMP Incorporated 140 Fourth Avenue Waltham, MA 02451-7599	
	CHECKED BY <i>BB</i> 4/24/92		
These drawings and specifications are the property of Omni Spectra Incorporated and shall not be reproduced or copied or used in whole or in part as the basis for the manufacture or sale of item(s) without written permission.	APPD BY <i>CAF</i> 4-27-92	<b>AMP</b> TITLE OS-2.9 2 HOLE FLANGE MOUNT JACK RECEPTACLE - FIELD REPLACEABLE NO. AP 408-04628 (48-007) USE ASSY PROCEDURE	
	SIZE B CODE IDENT NO. 26805 4852-3575-02 REV 03 <sub>0</sub>		
	SCALE 4:1 SHEET 1 OF 1		

CUSTOMER DRAWING

AMP PART # 1060031-1  
SHEET 1 OF 1 REV B