

THIS DRAWING IS UNPUBLISHED. RELEASED FOR PUBLICATION
 © COPYRIGHT - TE CONNECTIVITY ALL RIGHTS RESERVED.

LOC		DIST		REVISIONS			
P	LTR	DESCRIPTION	DATE	DWN	APVD		
W		ECR-10-020218	28DEC2010	PS	PKS		
WI		3-338088-3 (HALOGEN FREE) ADDED	24AUG2011	PS	RRP		

NOTES:

- 1 TOLERANCES UNLESS OTHERWISE SPECIFIED: ±0.15.
- 2 CONTACT PLATING:
OVERALL: Ni 1.27µm MIN. ALL OVER THE CONTACTS
SOLDER ZONE: Sn 3.5-5.0µm ON THE SOLDER ZONE OF THE CONTACT
MATING ZONE: PLATING CONFIRMS TO PRODUCT REQUIREMENTS AS PER SPECIFICATION 108-19117
- 3 CONTACT AND BRACKET MATERIAL:
CONTACTS: PHOSPHOR BRONZE
SOLDER BRACKET: TINPLATED BRASS WITH NICKEL UNDERLAYER.
- 4 THIS JACK CAN ALSO BE APPLIED HANGING THROUGH A HOLE, IN A PRINTED CIRCUIT BOARD. SEE LEFT PCB LAYOUT.
- 5 SURFACE CAN BE USED FOR PICKING THE MODULAR JACK WITH, TYPE 11 SMD MACHINE.
- 6 MEASURED AT HEEL OF CONTACTS, COPLANARITY AT TIPS MAX. 0.18mm.
- 7 TAPE AND REEL PACKAGING ACCORDING TO EIA 481-3 SPECIFICATIONS.
- 8 INCLUDES KAPTON TAPE (10mm x 14mm) ON TOP SURFACE FOR PICK AND PLACE UNIT
- 9 OBSOLETE
- 10 HOUSING MATERIAL:
HOUSING: 30% G.F. P.A 9T, COLOR BLACK, UL 94V-0.
- 11 HOUSING MATERIAL:
HOUSING: 30% G.F. LCP (HALOGEN FREE), COLOR BLACK, UL 94V-0.

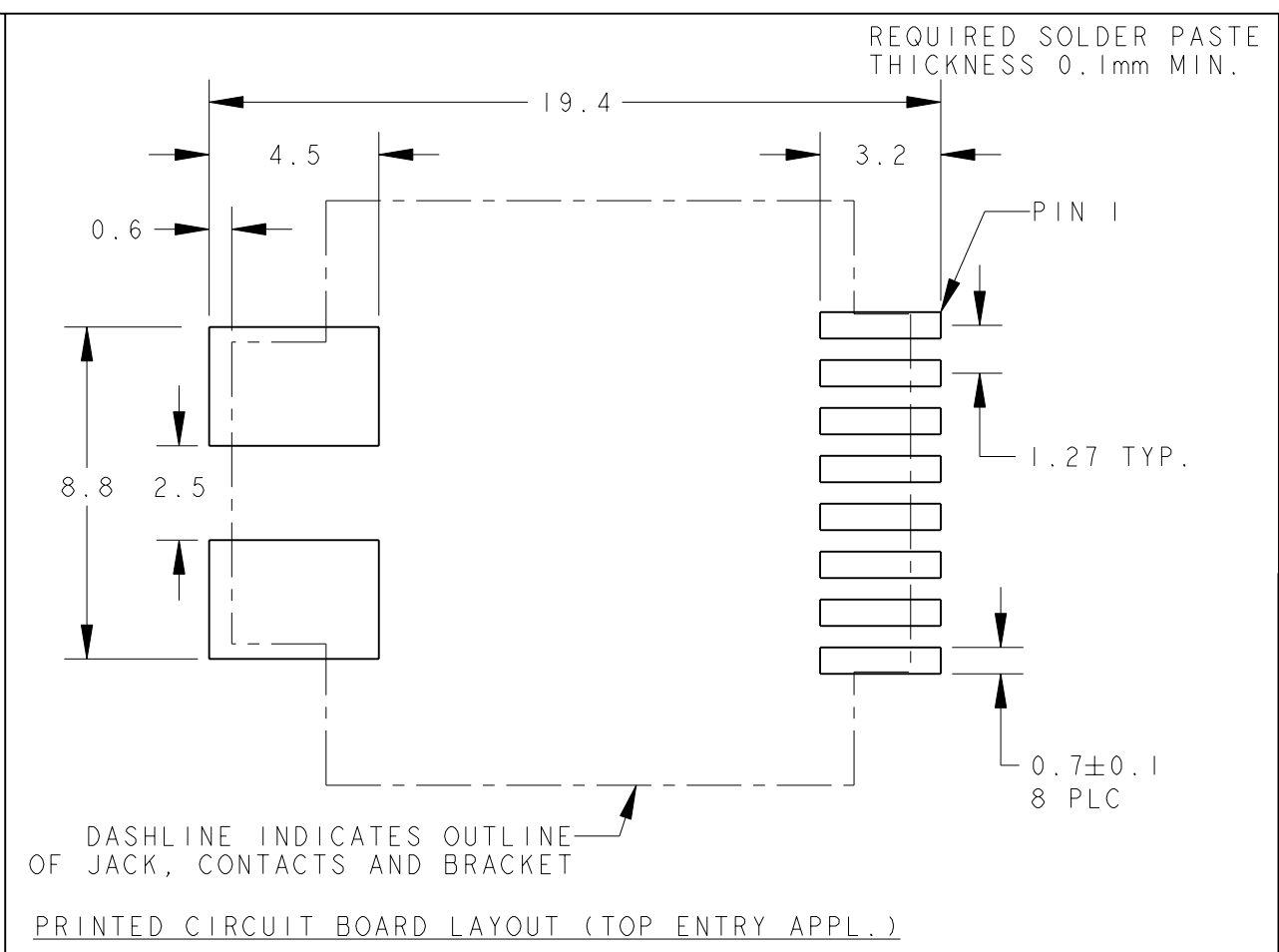
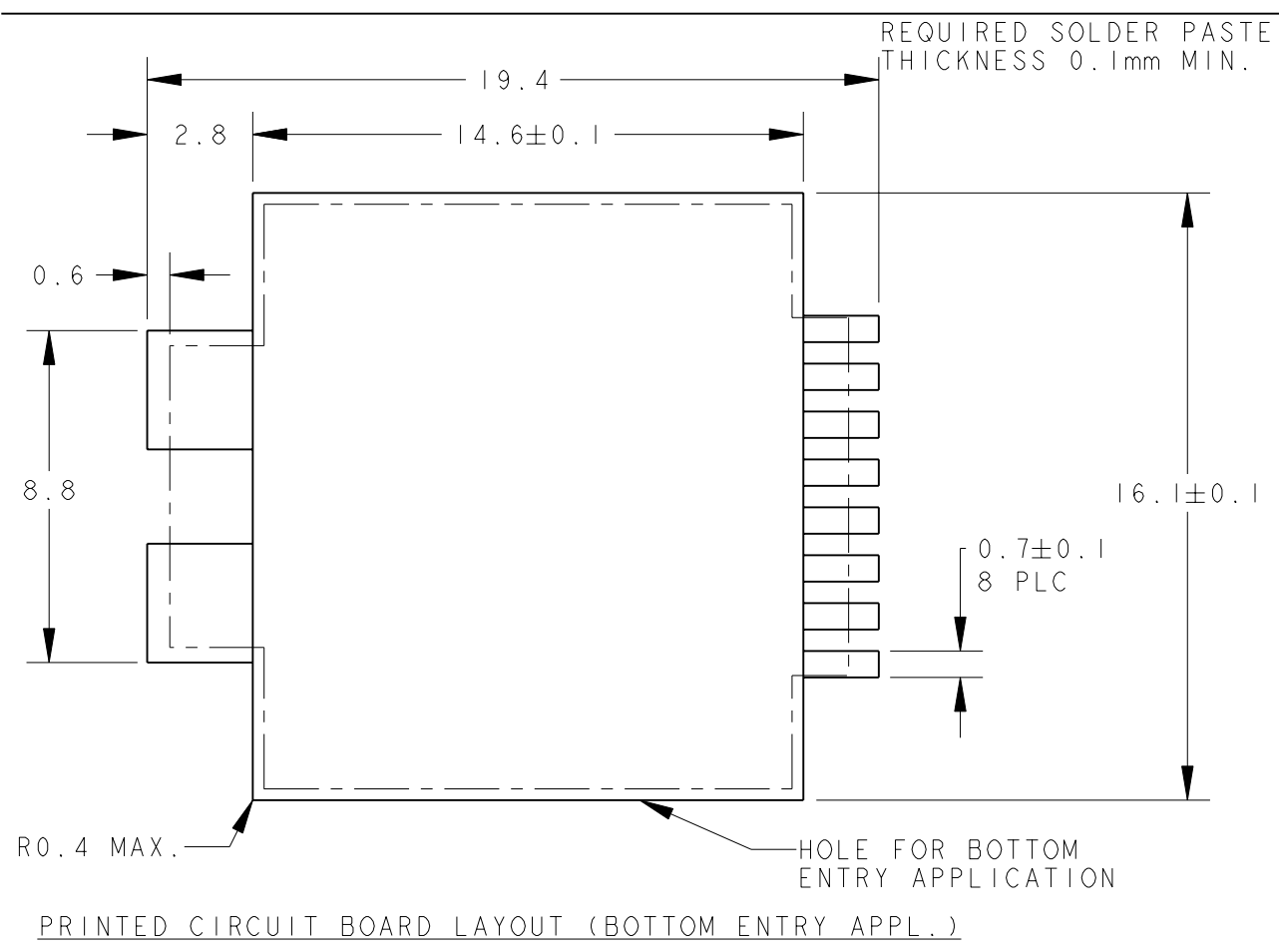
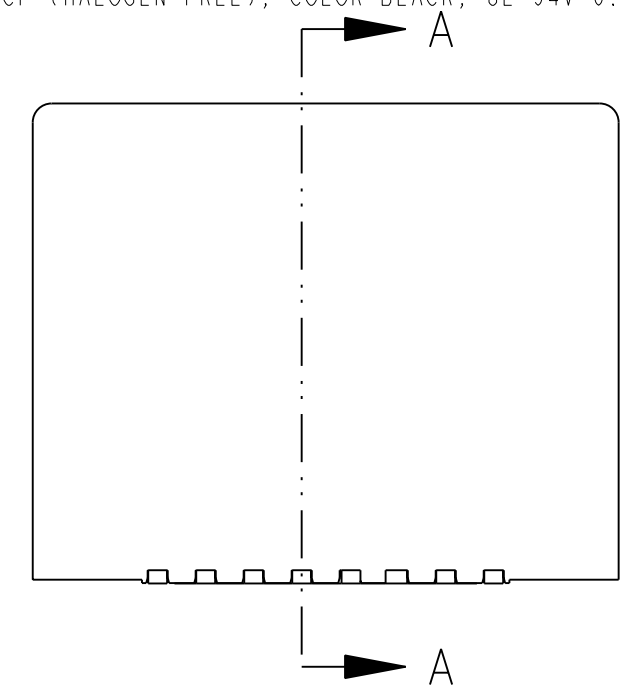
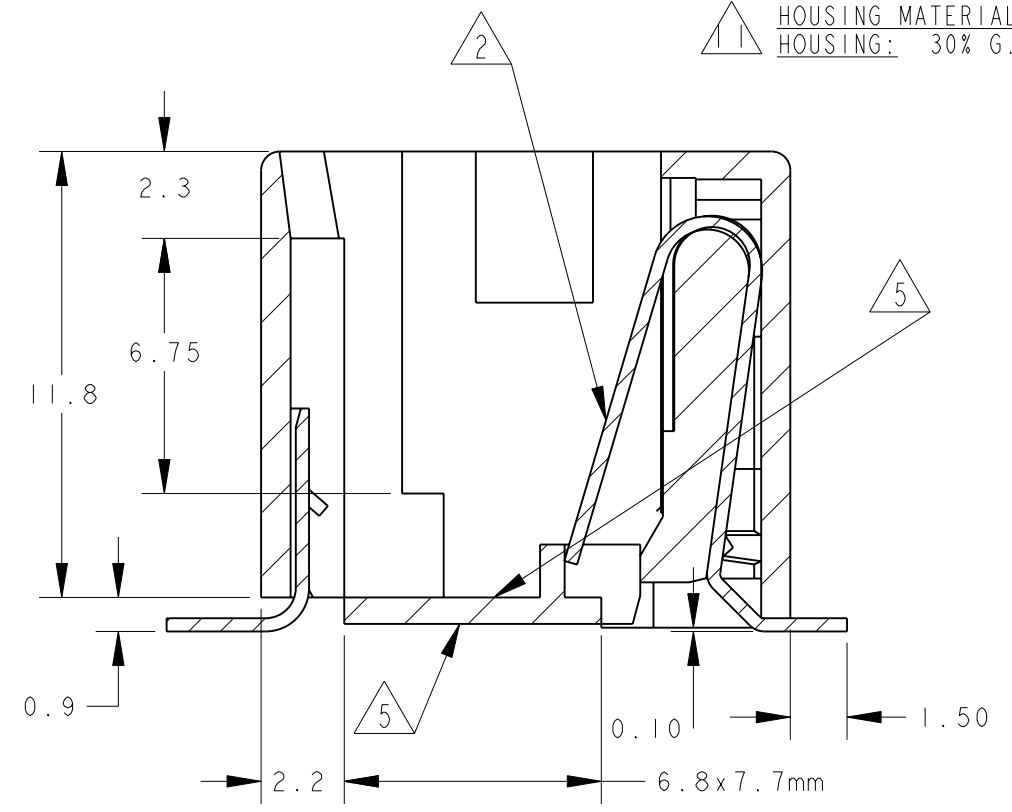
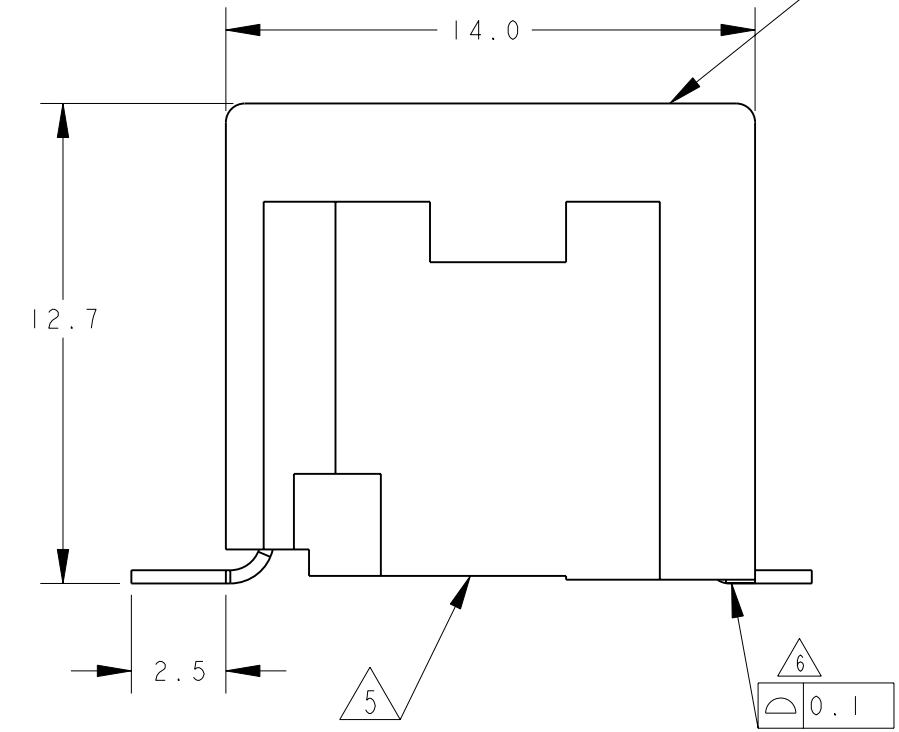
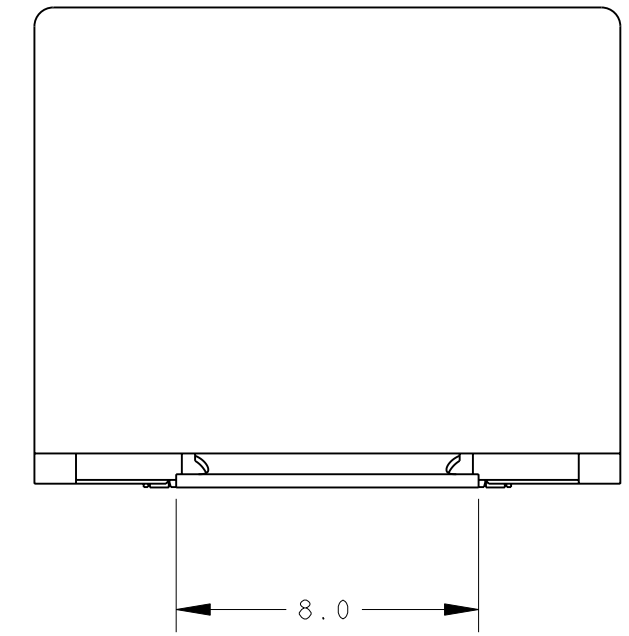
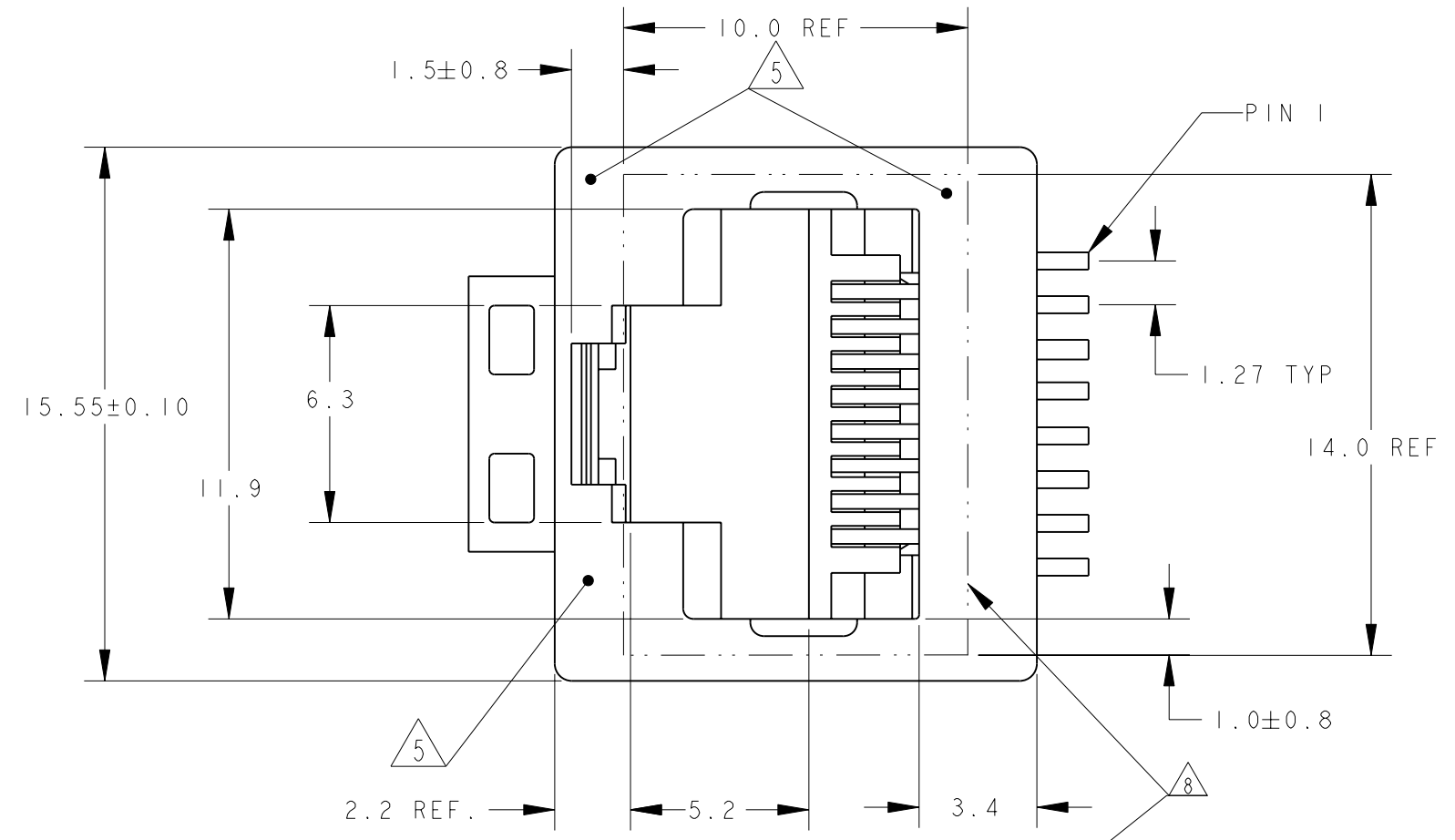
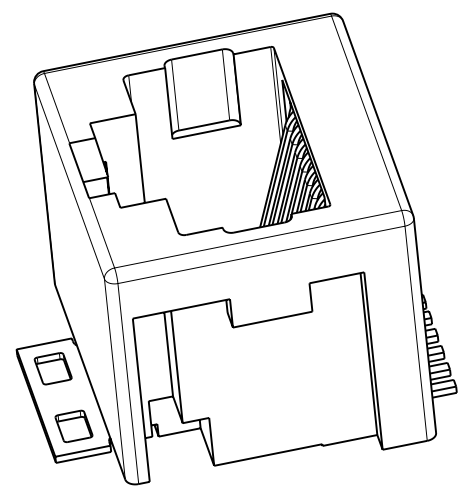

8 POSN./8 CONTACT	250 PCS ON Ø360mm OD REEL TOP ENTRY ORIENTATION PER DETAIL B1	3-338088-3
8 POS./8 CONTACT	250PCS ON Ø360mm OD REEL TOP ENTRY ORIENTATION PER DETAIL B1 WITH KAPTON TAPE FOR PICK AND PLACING	1-338088-6
8 POSN./8 CONTACT	250 PCS ON Ø360mm OD REEL BOTTOM ENTRY ORIENTATION PER DETAIL B2	1-338088-5
8 POSN./8 CONTACT	500 PCS ON Ø560mm OD REEL TOP ENTRY ORIENTATION PER DETAIL B1	2-338088-3
8 POSN./8 CONTACT	250 PCS ON Ø360mm OD REEL TOP ENTRY ORIENTATION PER DETAIL B1	1-338088-3
REMARKS	PACKAGING	PART NUMBER

THIS DRAWING IS A CONTROLLED DOCUMENT.

DWN: E.v.ELJK 30-Sep-96
 CHK: E.STELLINGA Dec-96
 APVD: R.SMEETS
 PRODUCT SPEC: 108-19117
 APPLICATION SPEC: 114-19041
 MATERIAL: SEE NOTE 3-
 FINISH: SEE NOTE 2-
 WEIGHT: 2.1 gr
 CUSTOMER DRAWING

STE TE Connectivity

INVERTIBLE MODULAR JACK,
8 POSITION
SURFACE MOUNT APPLICATION

SIZE: A2 CAGE CODE: 0779 DRAWING NO: 338088 RESTRICTED TO: -
 SCALE: 5:1 SHEET 1 OF 2 REV: W1

THIS DRAWING IS UNPUBLISHED. RELEASED FOR PUBLICATION
 © COPYRIGHT - TE CONNECTIVITY ALL RIGHTS RESERVED.

LOC	DIST	REVISIONS			
P	LTR	DESCRIPTION	DATE	DWN	APVD
IR	-	SEE SHEET 1	-	-	-

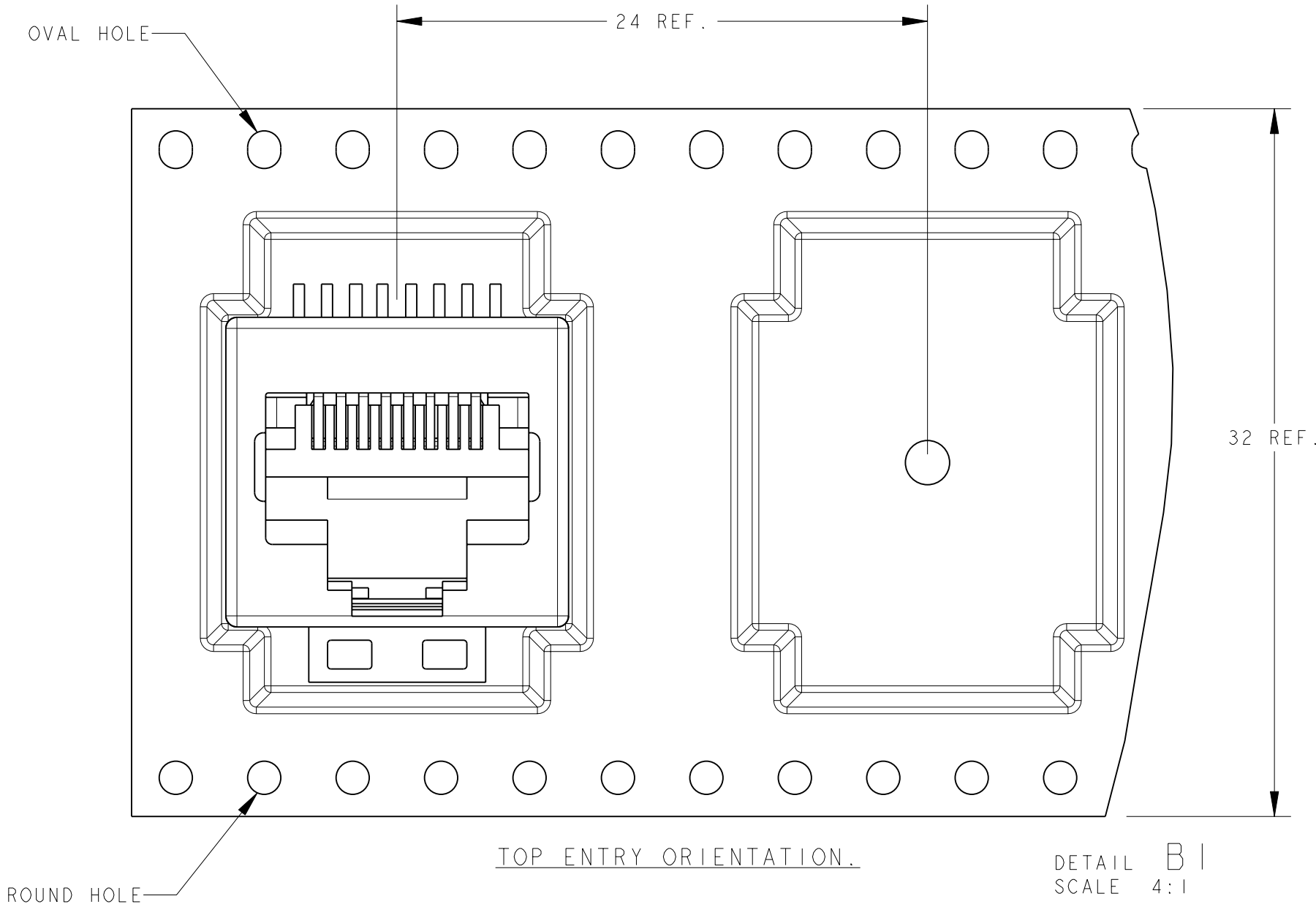

SEE DETAIL B1 & B2

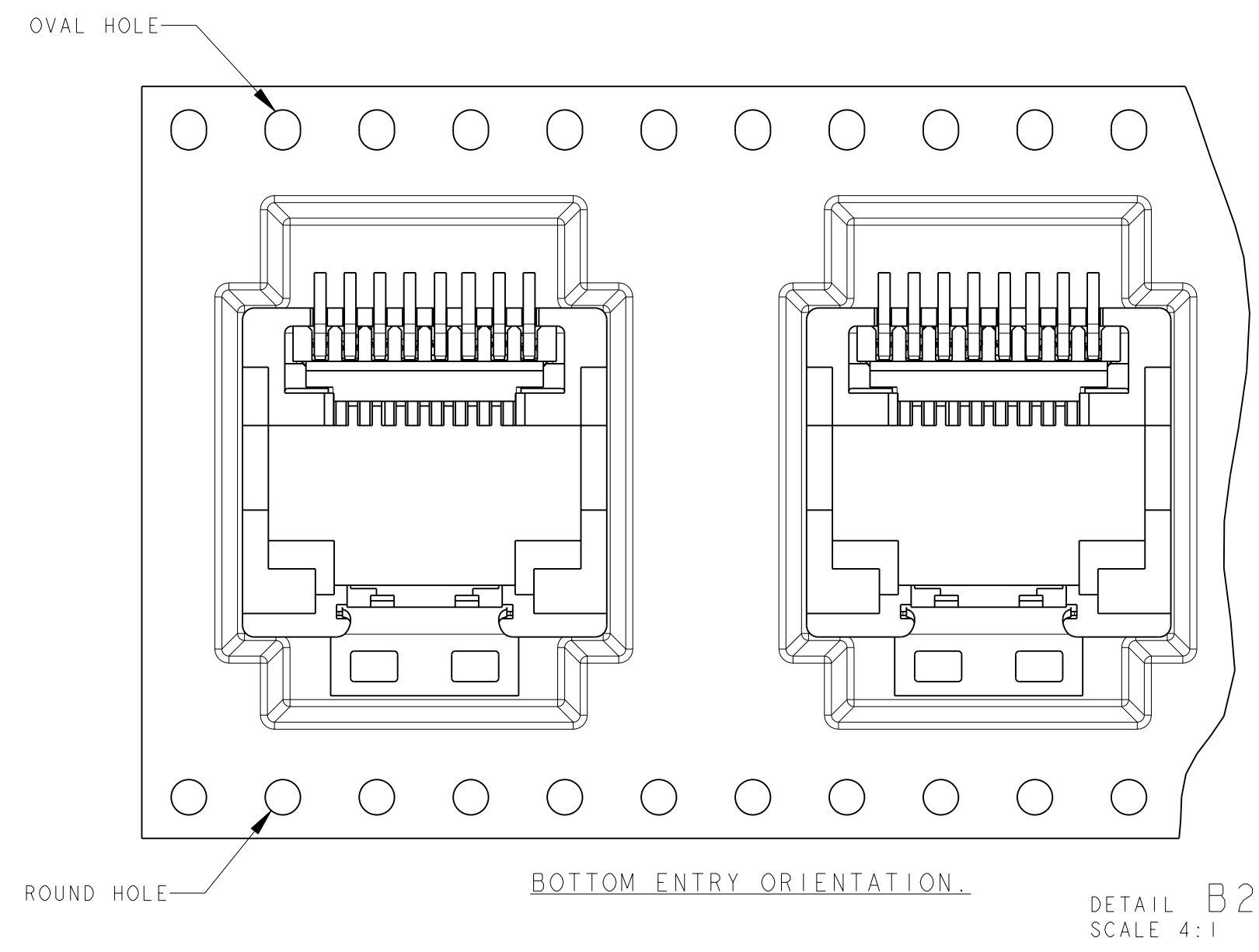
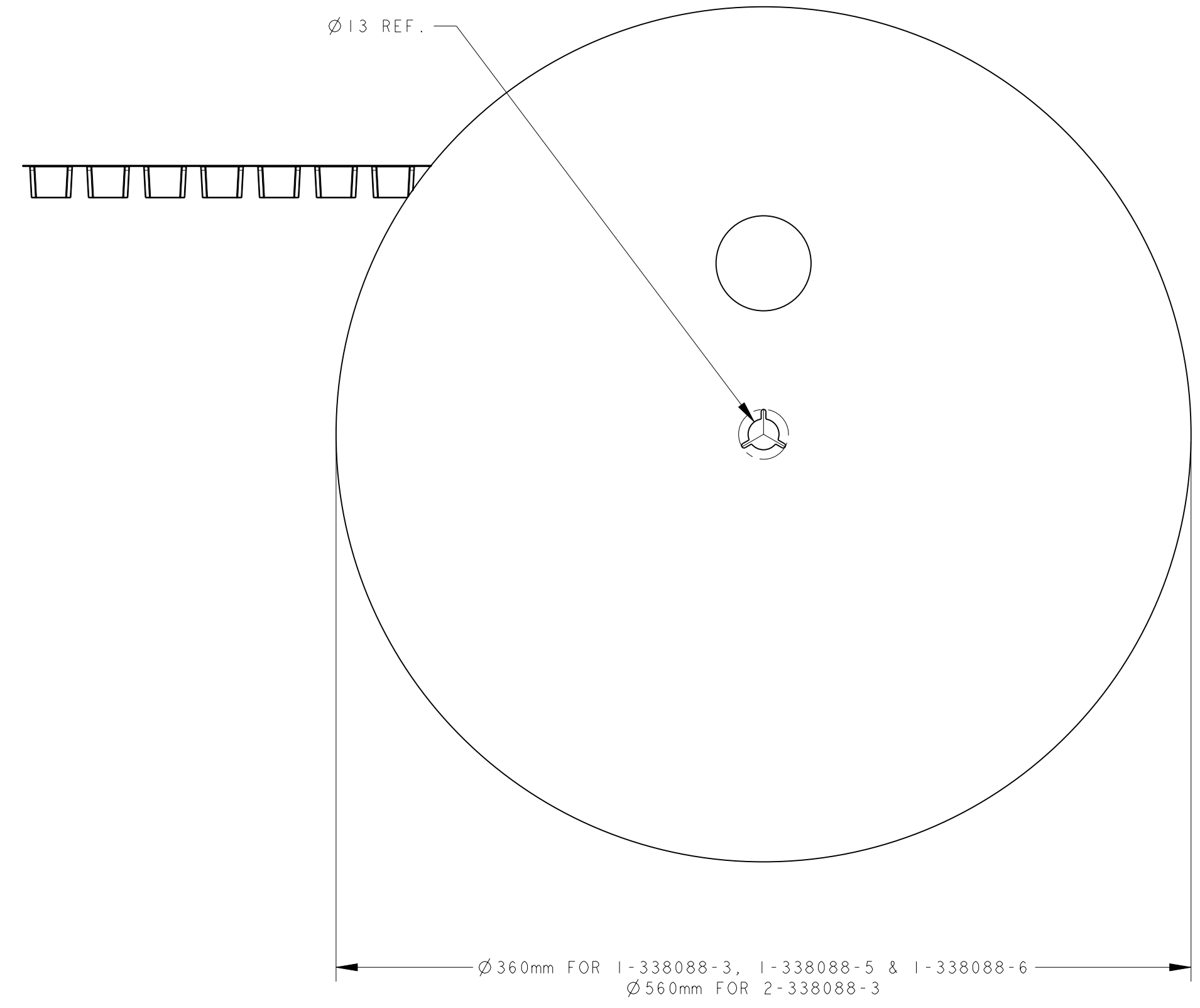
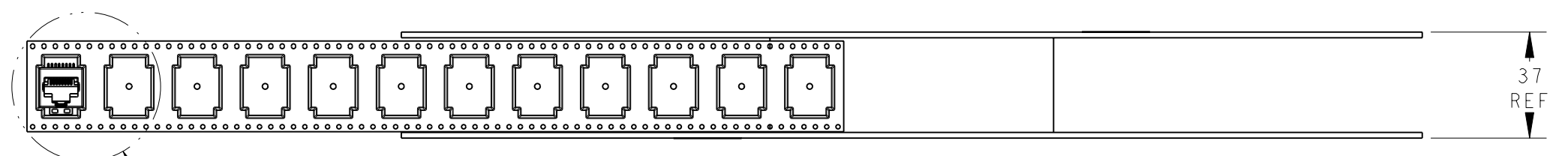

THIS DRAWING IS A CONTROLLED DOCUMENT.		DWN E.v.ELJK 30-Sep-96	TE Connectivity	
DIMENSIONS: mm		CHK E.STELLINGA Dec-96		
TOLERANCES UNLESS OTHERWISE SPECIFIED:		APVD R.SMEETS	NAME INVERTIBLE MODULAR JACK, 8 POSITION SURFACE MOUNT APPLICATION	
0 PLC ±	1 PLC ±	PRODUCT SPEC 108-19117	SIZE	CAGE CODE
2 PLC ±	3 PLC ±	APPLICATION SPEC 114-19041	DRAWING NO	RESTRICTED TO
4 PLC ±	ANGLES ±	WEIGHT 2.1 gr	A20779	C-338088
FINISH		CUSTOMER DRAWING	SCALE 5:1	SHEET 2 OF 2